

LEGEND
 ULTIMATE RUNWAY —————
 ZONE BOUNDARY —————
 AERIAL CONTOURS 1200
 SECTION LINES - - - - -
 TOPOGRAPHIC CONTOURS 1/30

PREPARED BY
**KOEHNLEIN
 LIGHTOWLER
 JOHNSON**
 INCORPORATED
 ARCHITECTS
 ENGINEERS
 CITIZENS BANK BUILDING
 BOX 121
 MORRIS, MINN. 56267
 564-885-1067
 17 SO. 7TH ST.
 BOX 2464
 FARGO, N.D. 58102
 701-233-1350
 DATE - MAY 1974
 PROJECT NO. 7425

MORRIS MUNICIPAL AIRPORT ZONING PLAN MORRIS, MINNESOTA		
MORRIS-STEVENS COUNTY AIRPORT ZONING BOARD		
APPROVAL <i>James H. Martin</i>	DATE <i>2/23/1974</i>	
APPROVAL <i>Earl Johnson</i>	DATE <i>6/23/1974</i>	
APPROVAL	DATE	
REVISIONS		
NO.	DESCRIPTION	DATE
DRAWN BY HAÅK		JULY 1974

NOTES:
 1. TOPOGRAPHIC CONTOUR INTERVALS ARE 10 FEET.
 2. DATUM IS MEAN SEA LEVEL ELEVATION.
 3. THE AERIAL CONTOURS ILLUSTRATE THE HEIGHT LIMITATIONS WITHIN EACH ZONE.
 4. A SLOPE, SUCH AS 50:50, EXPRESSES THE HORIZONTAL DISTANCE OF 50 FEET TO THE VERTICAL DISTANCE OF 1 FOOT.
 5. EXISTING TOPOGRAPHICAL SYMBOLS ARE THOSE USED BY THE U.S. GEOLOGICAL SURVEY.
 6. SEE DETAIL OF THREE RUNWAYS AND THEIR RESPECTIVE AIRSPACE ZONES WITHIN THE HORIZONTAL ZONE ON SHEET 2.

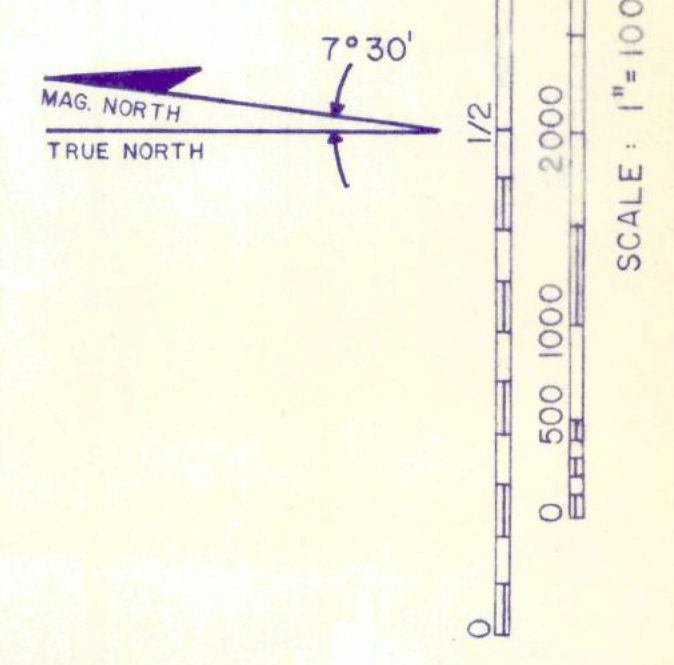
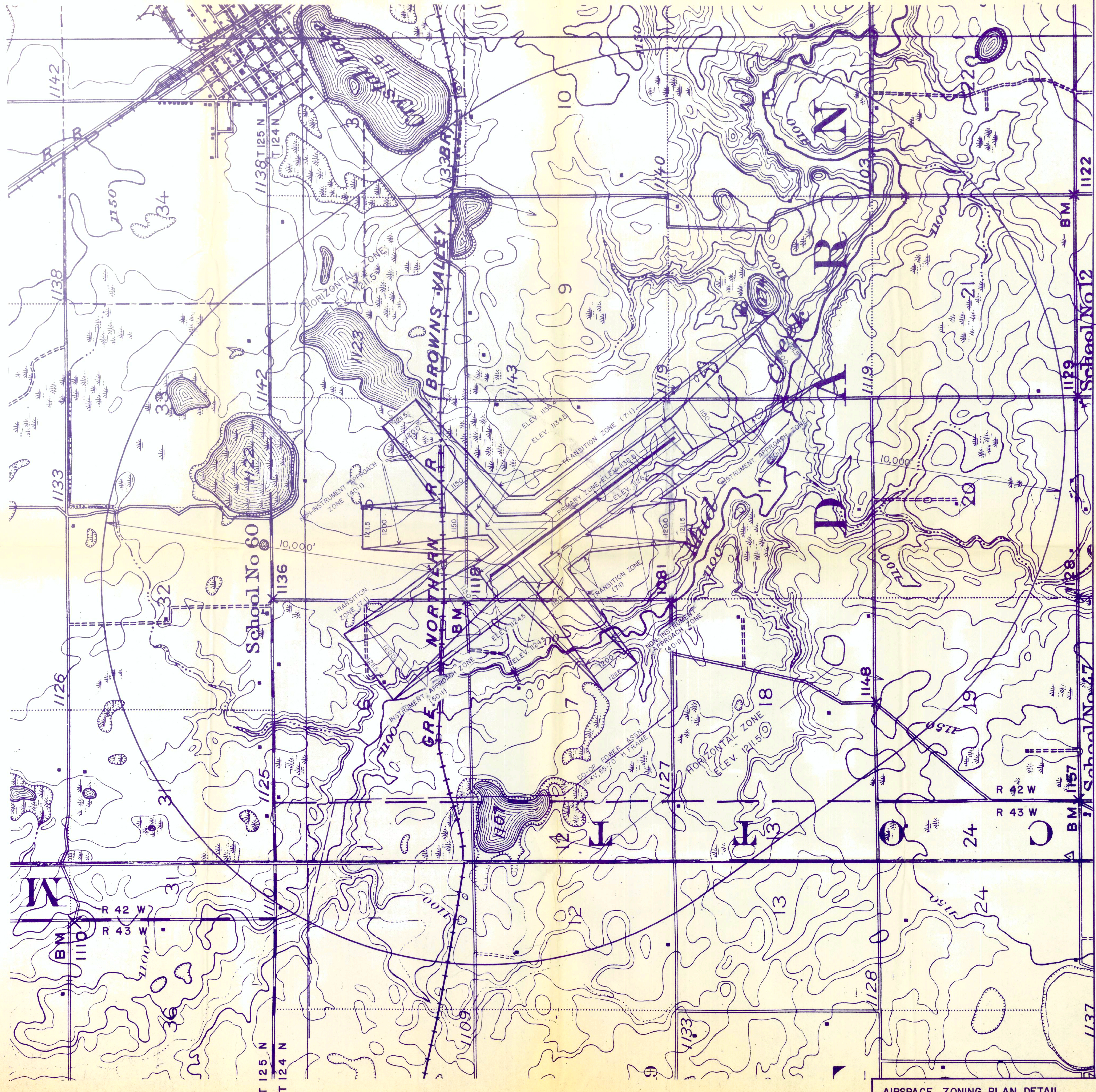

NOTE:
SEE SHEET NO. 1 OF 4 FOR
GENERAL NOTES + LEGEND

MORRIS MUNICIPAL
AIRPORT ZONING
PLAN

AIRSPACE ZONING PLAN DETAIL

SHEET NO. 2 OF 4 SHEETS

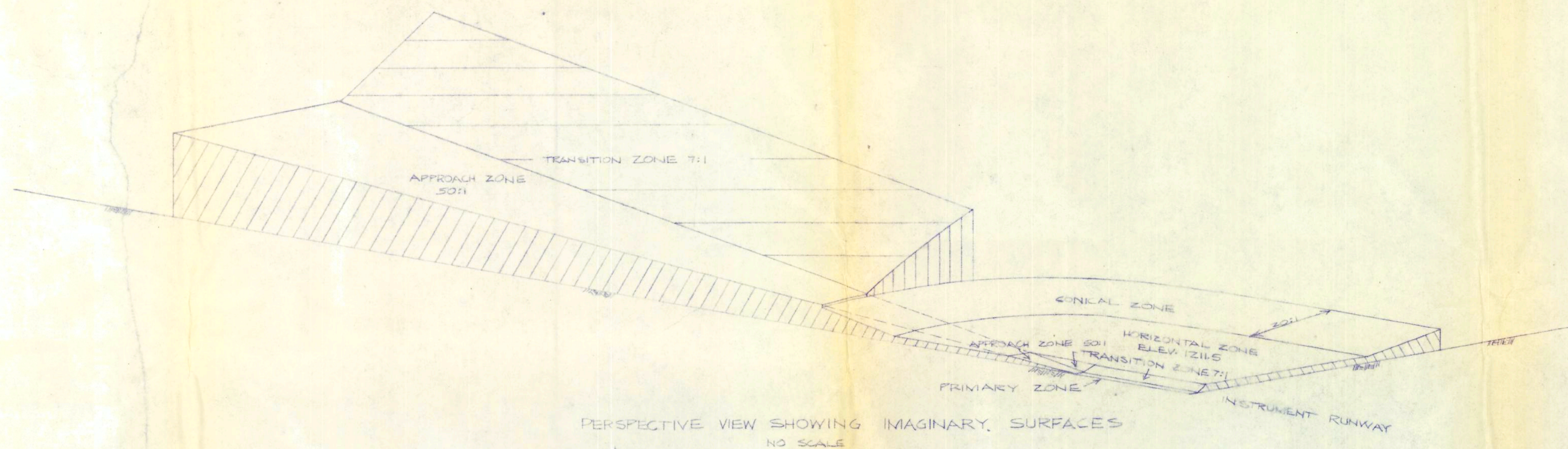

PERSPECTIVE VIEW SHOWING IMAGINARY SURFACES
NO SCALE

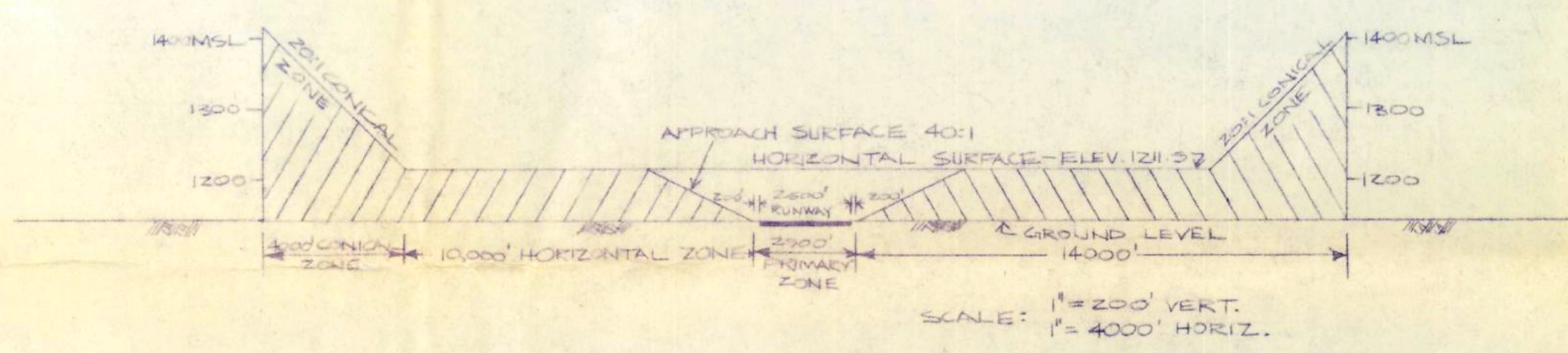

SECTION B-B

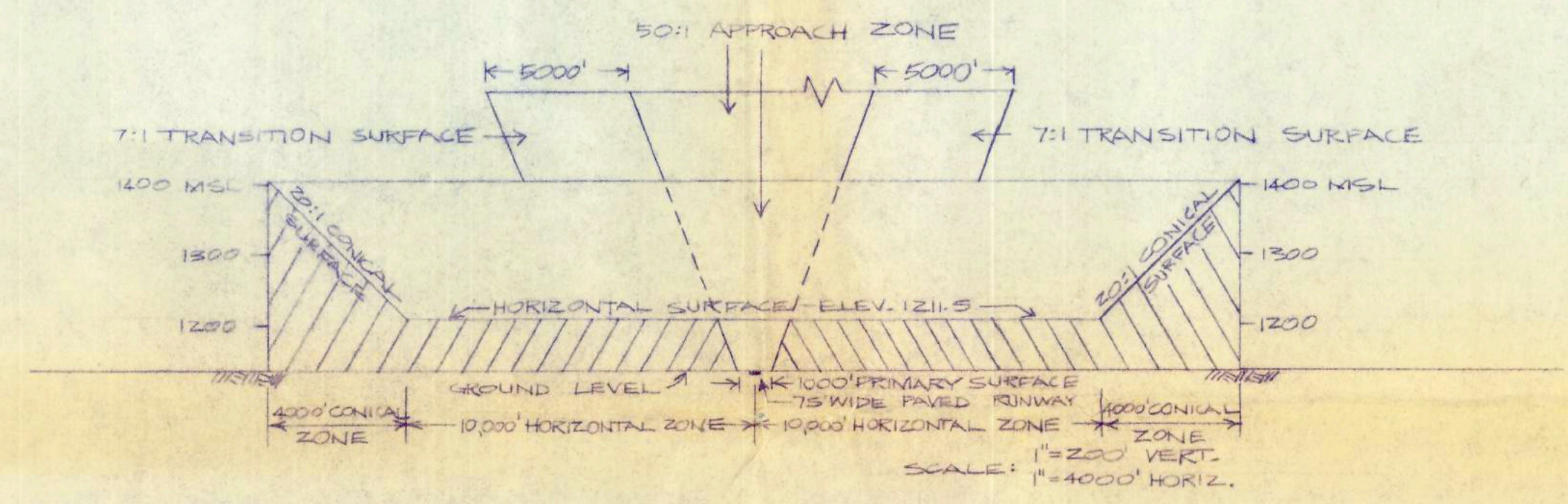

SECTION C-C

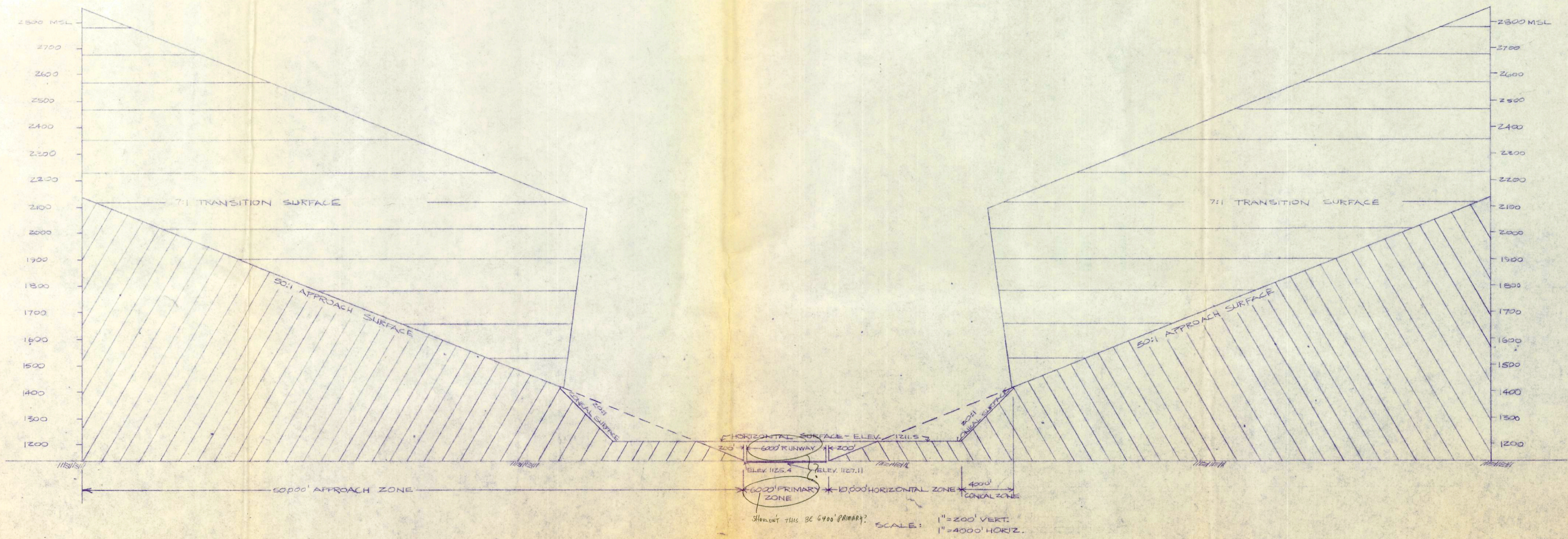

SECTION A-A

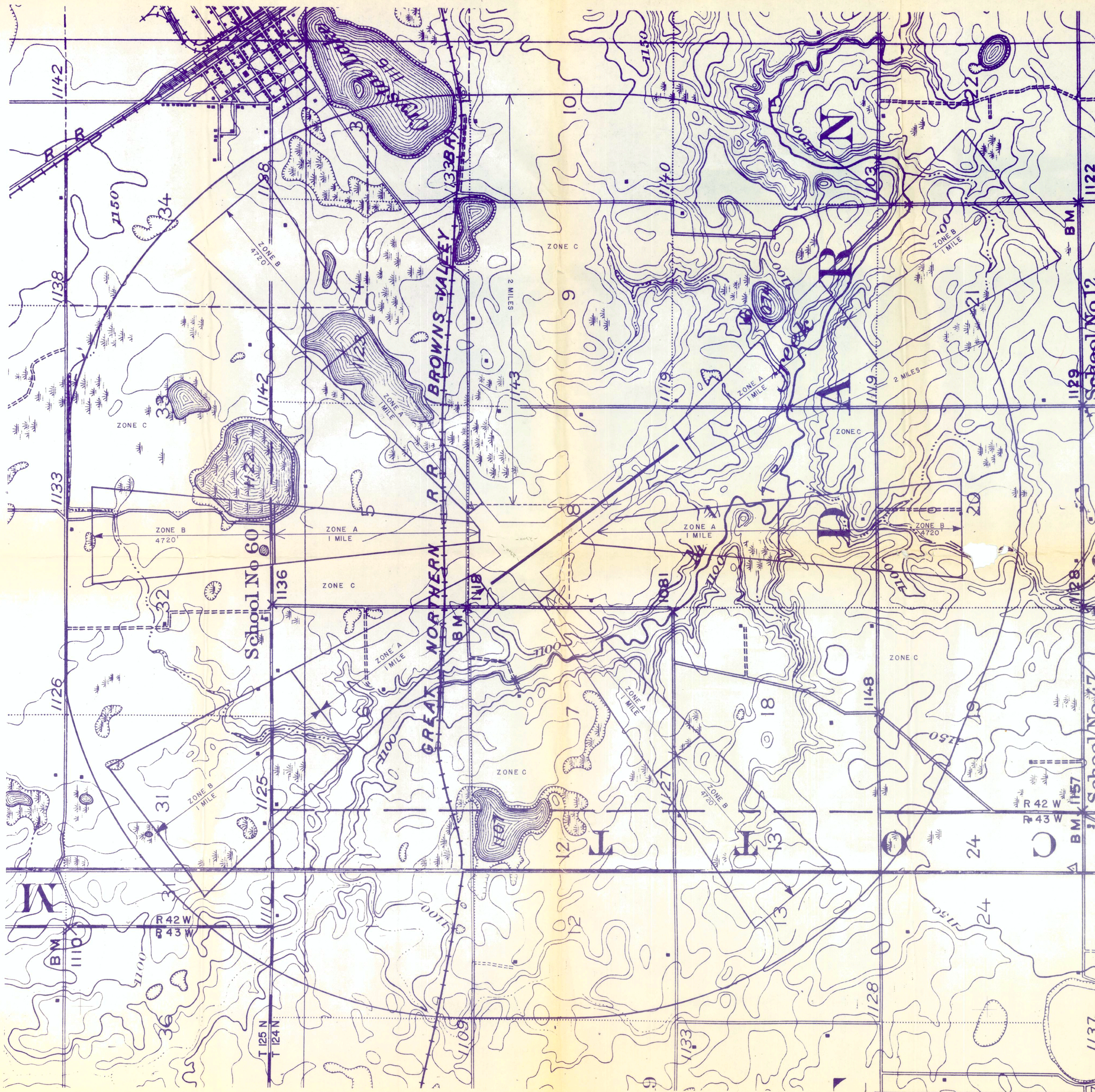

LEGEND
 ULTIMATE RUNWAY ———
 ZONE BOUNDARY ———
 SECTION LINES ———
 AIRPORT BOUNDARY - - - - -
 TOPOGRAPHIC CONTOURS ~120

NOTES:
 1. TOPOGRAPHIC CONTOUR INTERVALS ARE 10 FEET. DATUM IS MEAN SEA LEVEL ELEVATION.
 2. EXISTING TOPOGRAPHICAL SYMBOLS ARE THOSE USED BY THE U.S. GEOLOGICAL SURVEY.

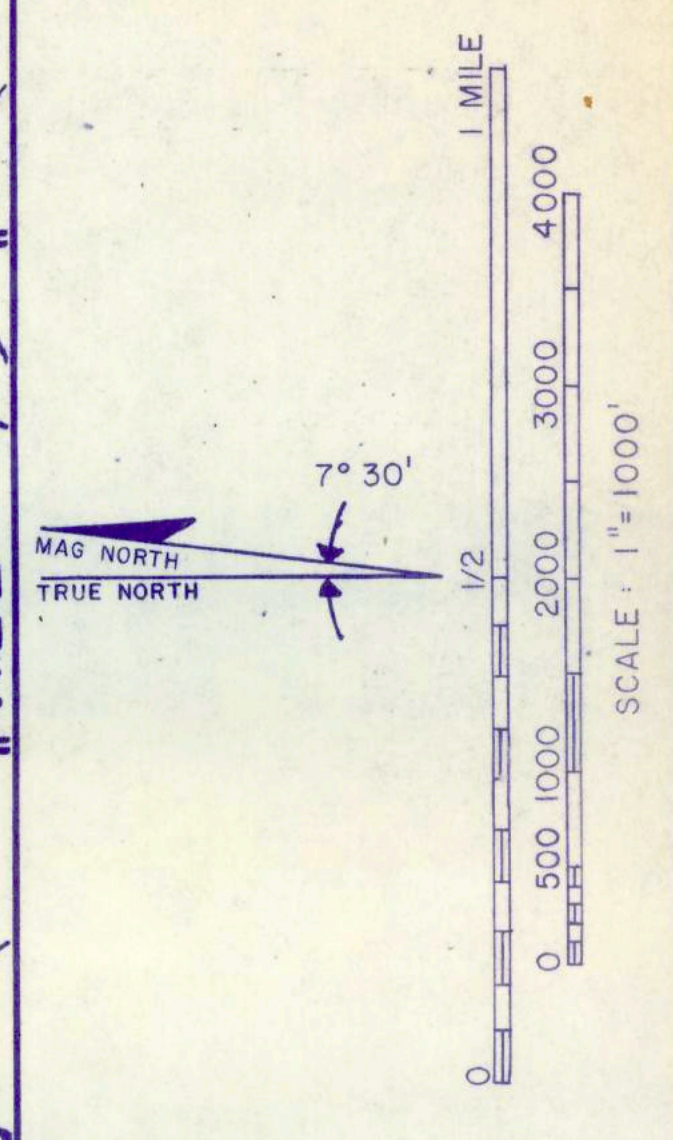

MORRIS MUNICIPAL AIRPORT ZONING PLAN